

PBX - Colour Coded Case & Bezel Safety Pattern Design

Ideal for industrial applications where high accuracy and durability is required and where the risk of Bourdon tube failure could compromise the safety of the operator.

All gauges are retro-fillable and totally repairable. A number of optional accessories are available either as factory fitted or retro-fitted. A Rhomberg vibration free movement (VFM) can be fitted where filling material is not allowed or excessive vibration is present.

The 54 mm dial size safety pattern design is especially suitable for welding and medical gas regulators. Solid front baffle and flimsy back blow-out for all bottom entry gauges to meet SABS and U.L. safety requirements as standard.

Case

P.B.T. Polybutyleneterephthalate - colour coded. Fully open back for maximum area to release pressure in case of major failure. Easy disassembly to allow access for calibration.

Bezel

P.B.T. Polybutyleneterephthalate - colour coded.

Back Plate

Fitting: non-screw fitting, locating by interface fit when used in conjunction with diaphragm
Back vented: to permit gauge "breathing"

Dual Purpose Diaphragm

Material: natural rubber
Operation: the diaphragm acts as a back plate seal and is stretched over the full diameter of the back plate, allowing for expansion of air or the filling medium in the gauge.

Adjustments

Either by removing bezel and window and using micro-adjust pointer or by removing the back plate and diaphragm and adjusting the movement.

Dampening Fluid

Glycerine (54 mm cannot be filled)

Configuration

A

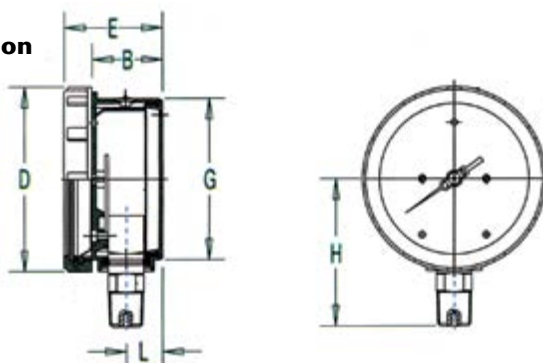

Nominal size

Conf. A

A

Dimensions

Metric	B	D	E	G	H	L
Imperial						
54 mm	22,50	59,00	34,50	55,00	51,00	11,50
2"	0,89	2,32	1,36	2,16	2,01	0,45
100 mm	45,00	114,40	62,00	100,00	91,50	22,50
4"	1,77	4,50	2,44	3,94	3,60	0,89
150 mm	45,00	163,00	62,00	145,00	117,50	22,50
6"	1,77	6,41	2,44	5,70	4,62	0,89



54mm (2") PBX gauge option

Non-fillable, with polycarbonate screw-on window and 'fold-back' blow out safety back

Internals: brass
Connections: 1/8 + 1/4 (BSP - NPT - BSBT)
Maximum Range: 60 MPa
Accuracy: 1,6 % FSD
Mass: ± 99 g

Mountings

Direct mounting only



Nominal Sizes

mm	54	100	150
Imp	2"	4"	6"

Pointer

Black aluminium, micrometer adjustable

Nett Mass

	100 mm	150 mm
Dry	±505 g	±800 g
Glycerine filled	±750 g	±1 500 g

Approvals

Explosion tests: in line with U.L. 404 which requires a controlled volume explosion bursting the Bourdon tube with the back plate dislodging in preference to the window
 IP 65 tests: approved, SABS 1062: approved

Accuracy

1 % FSD (Optional 0.5 % FSD)